



FE+ & FI+ Connection Verification™

(Patent Pending)



BE CONFIDENT IN YOUR CONNECTION

Use Connection Verification™ to:

Simplify Leak Testing

Eliminate Rework

Save Time & Money



- **Verify connections** are properly actuated **prior** to starting a leak test
- **Eliminate waste** caused by failed connections
- **Collect data** to verify operators have made the right connection
- **Automatically start leak tests** after the connection has been made
- **Improve safety** throughout the testing process

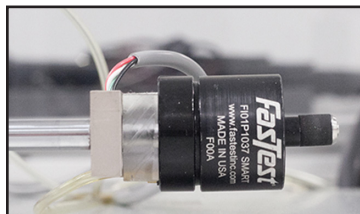

FOR VIDEOS & MORE INFORMATION



AVAILABLE AT FASTESTINC.COM

Connection Verification™ indicates the connector properly actuated

This unique technology provides greater connection accuracy and improves testing efficiency by reducing the number of failed tests due to improper or missed connections.

Applications:

Bench Top Leak Test Stations

Fully Automated Leak Test Cells

Pick & Place

Fluid Filling & Flow Testing



What happens to a leak-free product when the leak test station has a connection problem?

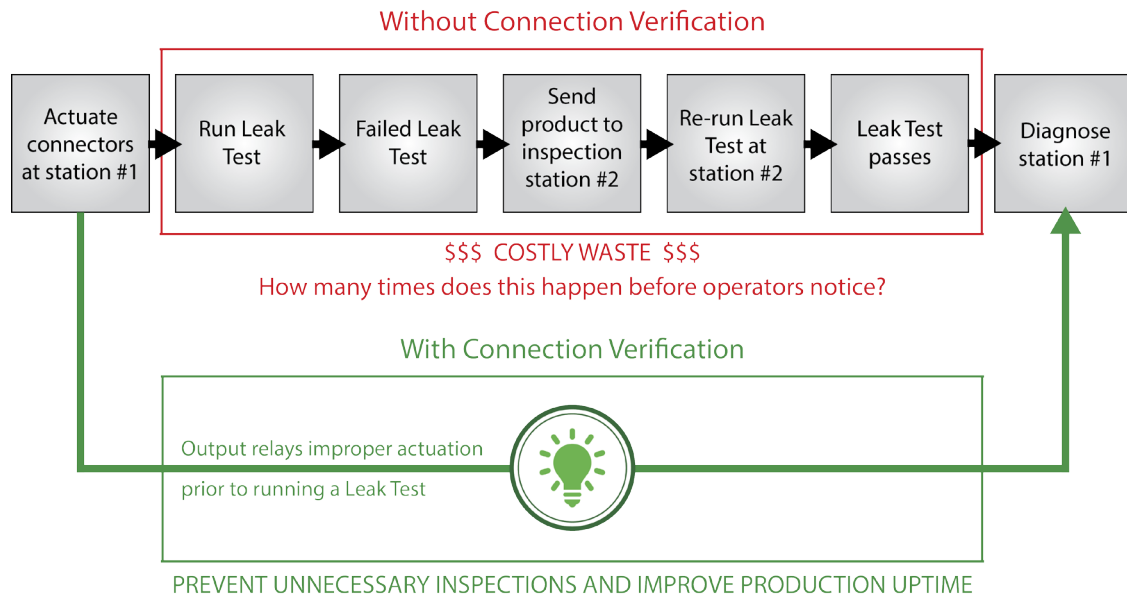

Specifications:

Product Family	Pressure Rating (psi)	Materials	Pilot Operation
FI Series	Vacuum to 120 psi	Aluminum and Stainless Steel	60 to 90 psi air supply
FE Series	Vacuum to 500 psi	Aluminum and Stainless Steel	60 to 600 psi air supply
Output Signal	Supply Voltage Range	Seal Material	Operating Temperatures
Sinking, NPN (max 100 mA load)	12V to 24V	Standard: Neoprene, Urethane Optional: FKM (Viton), Buna-N or EPDM	-0°F to 200°F (-17°C to 93°C) Neoprene 32°F to 175°F (0°C to 79°C) Urethane

*Maintains current FE and FI dimensions and can easily be retrofitted to previous applications

Easily Integrated Into Industry Standard PLC

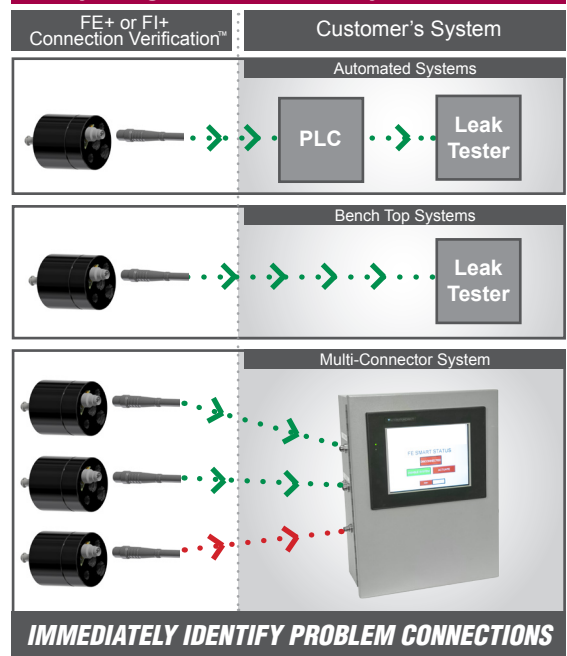

Want to Learn More About FasTest's Connection Verification™ Technology?
Contact FasTest Today!

Email: fastsales@fastestinc.com | Phone: 1-800-444-2373